

Event Set Up Guidelines for the Physical Sciences Building Atrium

 Egress Pathways - must be maintained free and clear

 Permissible event set up areas

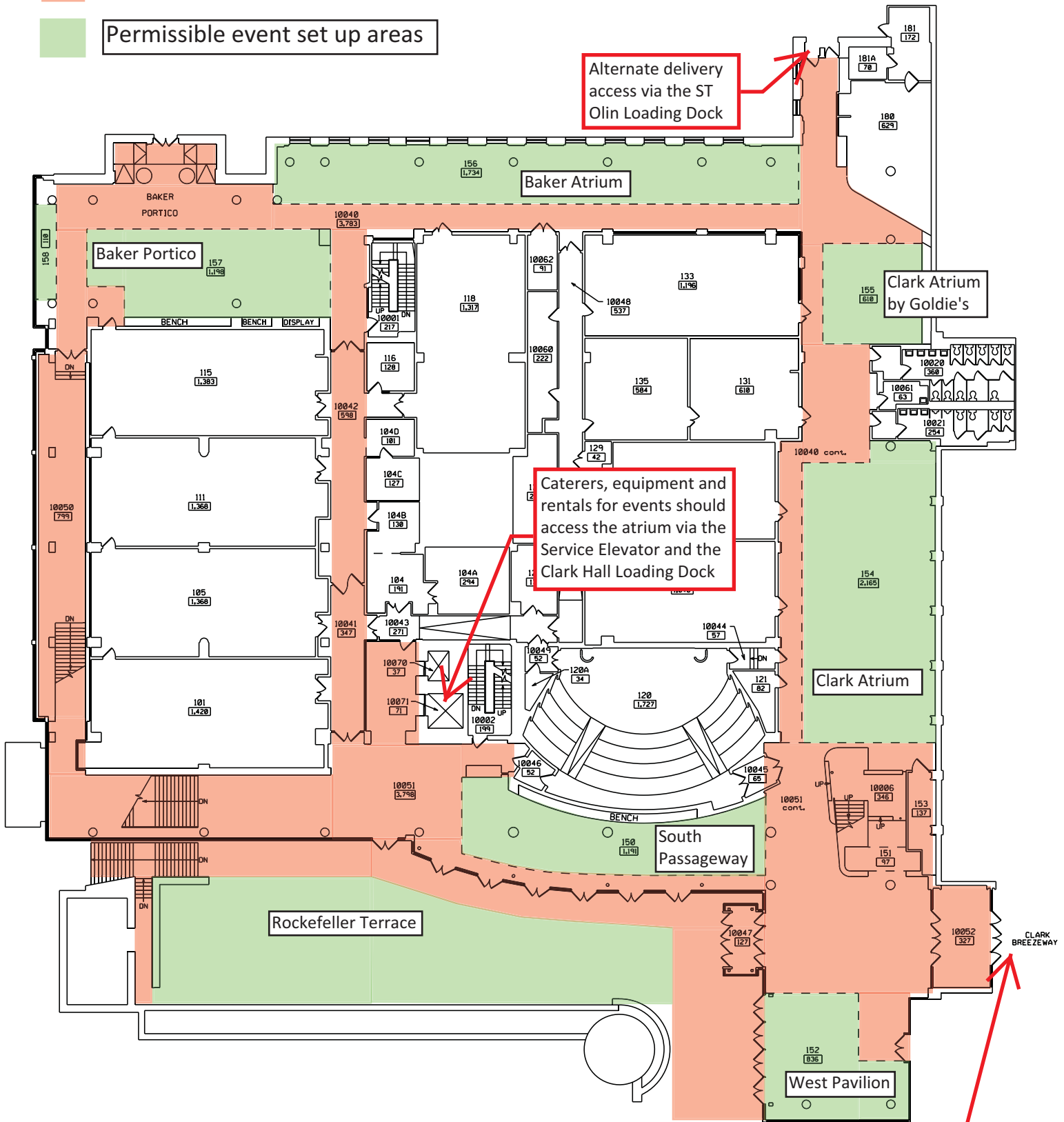

Alternate delivery access via the ST Olin Loading Dock

Caterers, equipment and rentals for events should access the atrium via the Service Elevator and the Clark Hall Loading Dock

Do not use the Clark Breezeway for deliveries